

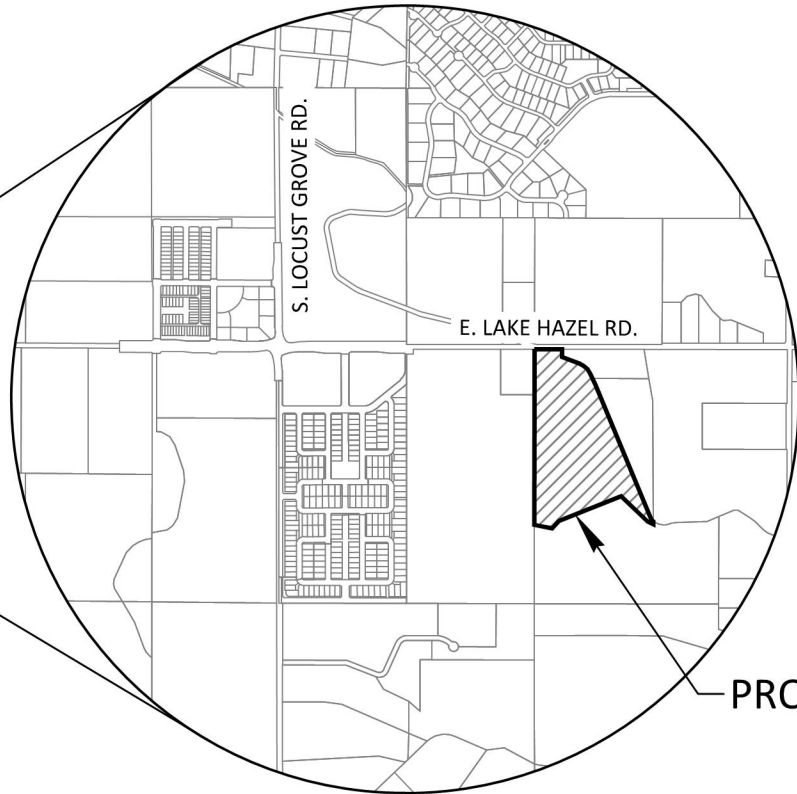

Project Information	Contacts Information	Fees Information	Reference Links
<hr/> <p>Application Number H-2021-0086</p> <p>Application Type Planning/Hearing/NA/NA</p> <p>Description Hearing Date: December 16, 2021 Assigned Planner: Alan Tiefenbach Request for rezoning of 32.21 acres of land from R-4 to the R-8 zoning district, development agreement modification to allow proposed development plan, and preliminary plat consisting of 97 building lots, and 14 common lots, by Brighton Development, Inc. Location: The site is located on Parcel # S1405120902, south of E. Lake Hazel Rd between S. Locust Grove Rd. and S. Eagle Rd, in a portion of Government Lot 2 and a portion of the SW ¼ of the NE ¼ of Section 5, Township 2N, Range 1E.</p> <hr/>			



VICINITY MAP

NO SCALE

km
ENGINEERING
 5725 NORTH DISCOVERY WAY
 BOISE, IDAHO 83713
 PHONE (208) 639-6939
 kmengllp.com

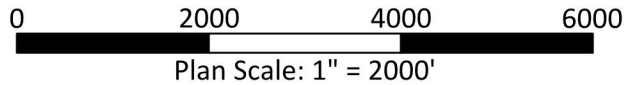
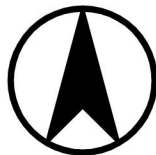

DATE: OCTOBER 2021
 PROJECT: 21-035

SHEET:
 1 OF 1

**APEX EAST SUBDIVISION
 MERIDIAN, IDAHO**

VICINITY MAP