

# Communities in Motion 2050 Development Checklist

The Community Planning Association of Southwest Idaho (COMPASS) is the metropolitan planning organization (MPO) for Ada and Canyon Counties. COMPASS has developed this review as a tool for local governments to evaluate whether land developments are consistent with the goals of Communities in Motion 2050 (CIM 2050), the regional long-range transportation plan for Ada and Canyon Counties. This checklist is not intended to be prescriptive, but rather a guidance document based on CIM 2050 goals.

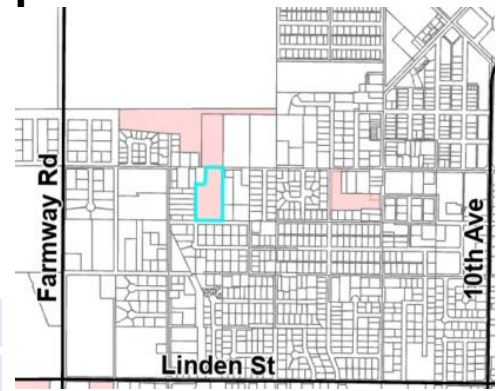

**Development Name:** Logan Village

**CIM Vision Category:** Existing Neighborhood    **New Jobs:** 0

**CIM Corridor:** None    **New Households:** 58



## Safety

Level of Stress measures how safe and comfortable a bicyclist or pedestrian would feel on a corridor and considers multimodal infrastructure number of vehicle lanes and travel speeds.

Pedestrian level of stress    n/a

Bicycle level of stress    n/a



## Economic Vitality

These tools evaluate whether the location of the proposal supports economic vitality by growing near existing public services.

- Activity Center Access
- Farmland Preservation
- Net Fiscal Impact
- Within CIM Forecast



## Convenience

Residents who live or work less than 1/2 mile from critical services have more transportation choices, especially for vulnerable populations

- Nearest bus stop
- Nearest public school
- Nearest public park



## Quality of Life

Checked boxes indicate that additional information is attached.

- Active Transportation
- Automobile Transportation
- Public Transportation
- Roadway Capacity



Improves performance



Does not improve or reduce performance



Reduces performance

### Comments:

The location is within 0.5 miles of the current [Route 43 - Caldwell Express](#) bus route. [Communities in Motion 2050](#) also identifies an additional five future bus routes with connections in downtown Caldwell. The higher density proposed is supportive of current and future transit service.

**Communities in Motion 2050**  
[2020 Change in Motion Report](#)  
[Development Review Process](#)

Web: [www.compassidaho.org](http://www.compassidaho.org)  
 Email: [info@compassidaho.org](mailto:info@compassidaho.org)



## ***Fiscal Impact Analysis Supplemental for the Development Review Checklist***

The purpose of the fiscal impact analysis is to better estimate expected revenues and costs to local governments as a result of new development so that the public, stakeholders, and the decision-makers can better manage growth. Capital and operating expenditures are determined by various factors that determine service and infrastructure needs, including persons per household, student generation rates, lot sizes, street frontages, vehicle trip and trip adjustment factors, average trip lengths, construction values, income, discretionary spending, and employment densities.

The COMPASS Development Checklist considers the level of fiscal benefits, how many public agencies benefit or are burdened by additional growth, and how long the proposal will take to achieve a fiscal break-even point, if at all.

More information about the COMPASS Fiscal Impact Tool is available at:  
[www.compassidaho.org/prodserv/fiscalimpact.htm](http://www.compassidaho.org/prodserv/fiscalimpact.htm)

### **Overall Net Fiscal Impact Net Fiscal Impact by Agency**

 City

 County

 Highway District

 School District

Break Even: 1 year