

# Communities in Motion (CIM) Development Review Checklist

Development Name: Terra View South Subdivision  
 CIM Vision Category: Future Neighborhood  
 Consistent with CIM Vision? YES  
 New Households: 301      New Jobs: ±570

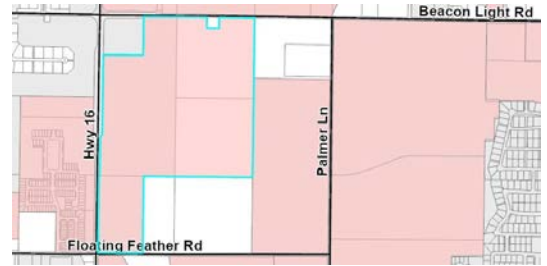

**Safety**  
 How safe and comfortable is the nearest major road (minor arterial or above) for bicyclists and pedestrians? Analysis is limited to existing roadway conditions.

*Beacon Light Road*

Pedestrian level of stress

Bicycle level of stress

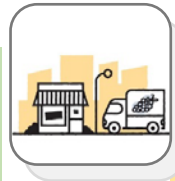

**Economic Vitality**  
 To what extent does the project enable people, government, and businesses to prosper?

Economic Activity Center Access

Impact on Existing Surrounding Farmland

Net Fiscal Impact N/A



**Convenience**  
 What services are available within 0.5 miles (green) or 1 mile (yellow) of the project?

Nearest bus stop

Nearest public school

Nearest public park



**Quality of Life**  
 Checked boxes indicate that additional information is attached.

Active Transportation

Automobile Transportation

Public Transportation

Roadway Projects



Improves performance



Does not improve or reduce performance



Reduces performance

**Comments:**

This proposal is a mix of residential and commercial, which can reduce congestion by decreasing the amount of single occupancy vehicle trips and encourage non-motorized travel. Provide sufficient crosswalks and bike parking to encourage pedestrian and bike trips.

**Who we are:** The Community Planning Association of Southwest Idaho (COMPASS) is the metropolitan planning organization for Ada and Canyon Counties. This review evaluates whether land developments are consistent with [Communities in Motion](#), the regional long-range transportation plan for Ada and Canyon Counties. This checklist is not intended to be prescriptive, but rather a guidance document. Past checklists are available [online](#). See the [Development Review User Guide](#) for more information on the red, yellow, and green checklist thresholds.

Sent: 11/1/23



<https://compassidaho.org/>



[info@compassidaho.org](mailto:info@compassidaho.org)



**COMPASS**  
 COMMUNITY PLANNING ASSOCIATION  
 of Southwest Idaho

## ***Complete Network Appendix***

Checkmarks (✓) below indicate suggested changes to a site plan, based on the [COMPASS Complete Network Policy \(No. 2022-01\)](#). Both the Complete Network Policy and site-specific suggestions are intended to better align land use with identified transportation uses in the corridor. Please see the Complete Network [map](#) for primary and secondary uses for roadways (minor arterial and above) in Ada and Canyon Counties.

**Corridor Name:** Beacon Light Road

**Primary Use:** N/A

**Secondary Use:** N/A

### **Bicycle and Pedestrian Infrastructure**

- ✓ Provide sidewalks, crosswalks, and micropaths to connect destinations
- ✓ Provide sufficient and covered bike parking near destinations

# Long-Term Funded and Unfunded Capital Projects

**CIM Priority Corridor:**

State Highway 16 (State Highway 44 to Deep Canyon Road)

Adding additional travel lanes and access management to State Highway 16 (State Highway 44 to Deep Canyon Road) is the number 7 state system priority in *Communities in Motion 2050* and is unfunded.

More information on transportation needs and projects based on forecasted future growth is available at: <https://cim2050.compassidaho.org/projects-and-priorities/project-priorities/>

## Short-Term Funded Capital Projects

**Study, SH-16, SH-44 to Junction SH-52, Environmental Re-evaluation**

Regionally Significant:

TIP Achievement:

Key #: 23175

Support

Requesting Agency: ITD

Project Year: PD

Total Previous Allocations: \$3,000

Total Programmed Budget: \$1

Total Cost (Prev. + Prog.): \$3,001

Project Description

Re-evaluate the environmental assessment regarding proposed improvements to State Highway 16 from State Highway 44 in Ada County to the junction of State Highway 52 in the City of Emmett in Gem County to reaffirm the Idaho Transportation Department's proposed improvements on the corridor. (Included as a "hold." Construction is unfunded.)

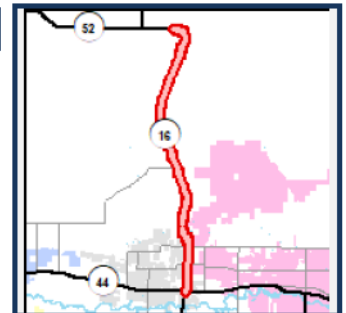

Funding Source	STBG-State			Program State Hwy - Early Development			Local Match 7.34%			
	Cost Year*	Preliminary Engineering	Preliminary Engineering Consulting	Right-of-Way	Utilities	Construction Engineering	Construction	Total	Federal Share	Local Share
PD	0	0	0	0	0	0	1	1	1	0
<b>Fund Totals:</b>	0	0	0	0	0	0	1	1	1	0

Source: *The COMPASS Transportation Improvement Program (TIP). The TIP is a short-range (seven-year) budget of transportation projects for which federal funds are anticipated, along with non-federally funded projects that are regionally significant and is available at:*

<https://compassidaho.org/transportation-improvement-program/>